



Holland Court

£349,000

Situated in one of Mill Hill's most sought after developments is the spacious 2 double bedroom first floor flat. The property comprises of 2 spacious double bedrooms, a family bathroom, separate w/c. In addition to a large living room leading onto a separate fully equipped modern kitchen. It is a wonderfully bright, tranquil and spacious property with plenty of storage space and a garage. It is share of freehold with over 950 years left on the lease. The management company are currently independently investing £200,000 in the common areas, parking and storage, with no cost to the owners.

Viewing

Please contact our London Office on 020 8959 0011 if you wish to arrange a viewing appointment for this property or require further information.



2



1



1



Floor Plan

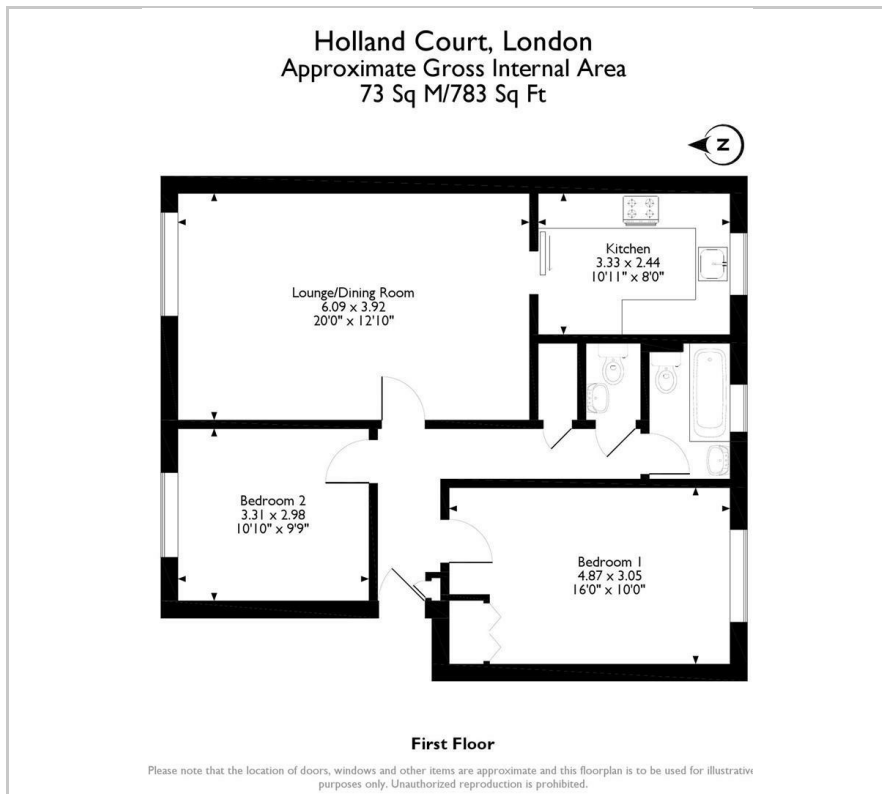

Area Map

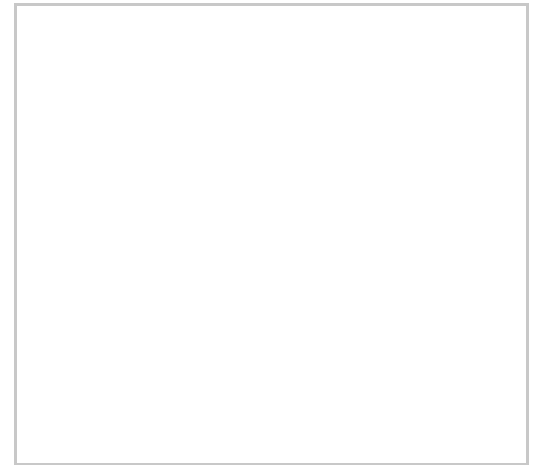

Energy Efficiency Graph



These particulars, whilst believed to be accurate are set out as a general outline only for guidance and do not constitute any part of an offer or contract. Intending purchasers should not rely on them as statements of representation of fact, but must satisfy themselves by inspection or otherwise as to their accuracy. No person in this firm's employment has the authority to make or give any representation or warranty in respect of the property.